

Revision 1

January 2006



**BATCA**  
fitness systems · usa

# S-9

Shoulder Press

## Owner's Manual

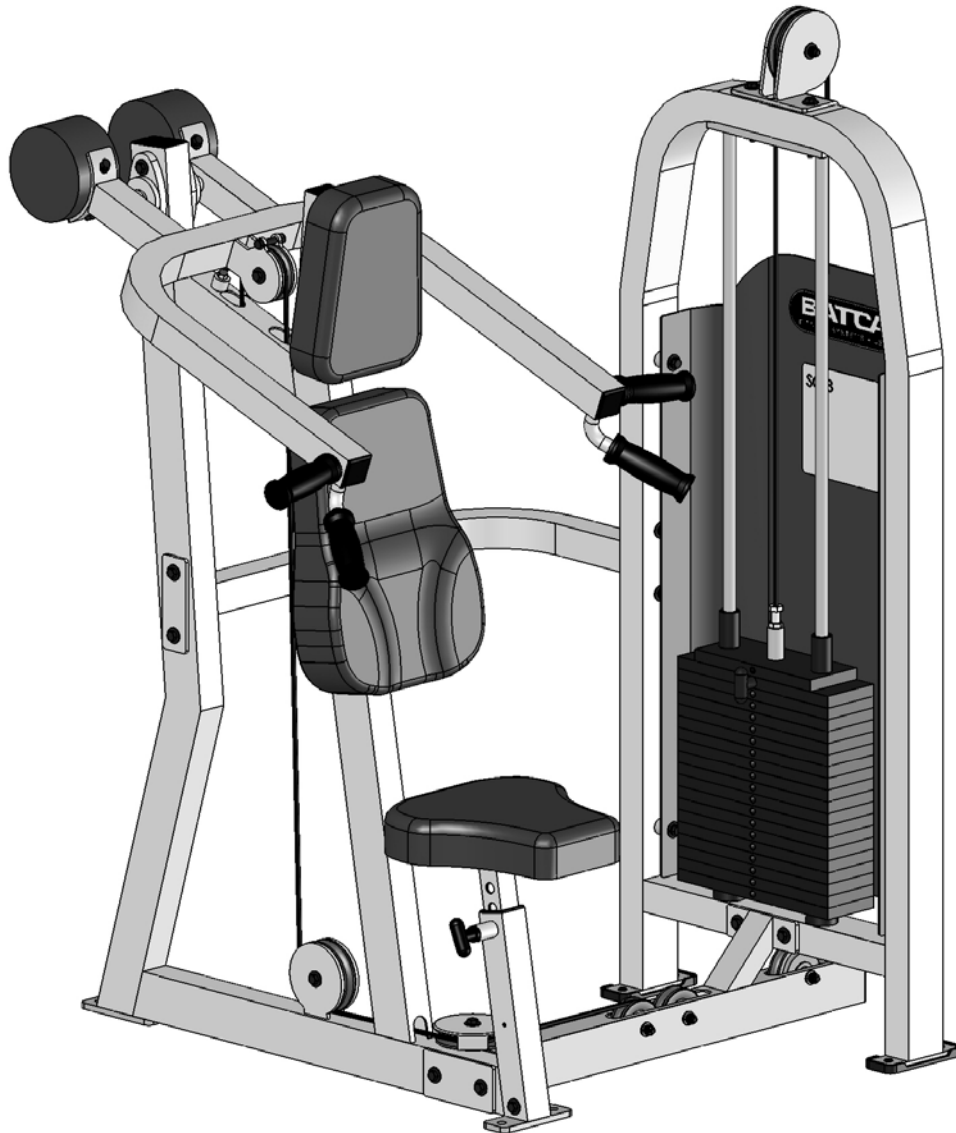

**Record Serial Number Here**

**Date of Purchase**

Batca Fitness Systems  
Tel. (919) 255-1233  
[www.batcafitness.com](http://www.batcafitness.com)

# Instructions

Congratulations on the purchase of your new Batca S-9. This gym will provide you with a lifetime of enjoyment to meet your strength training needs. Batca Fitness Systems strives to build the best quality gyms and to package these gyms in such a way to avoid any damage during shipping.

In order to get started with your assembly you should first familiarize yourself with this manual. It is recommended that you read through each step thoroughly before you begin. Begin by opening your boxes and separating all of your parts. Verify that all parts are accounted for and have no damage. When all parts are accounted for, you may begin your assembly. Some items may have been pre-assembled for your convenience. Please note that hardware quantities shown reflect total quantities for your gym and may not reflect actual quantities in each bag. Assemble your gym on a solid level surface. This will ensure the best possible performance, function, and safety for the gym and your workout.

Assemble your gym according to the step by step instructions found in this manual. Failure to do so will void your warranty and may result in personal injury. After assembly, you should check each station to ensure correct operation. If a problem arises, recheck your assembly with these instructions to verify correct assembly. If you are unable to correct a problem or have questions with your assembly please contact your authorized Batca dealer.

# Warning

Batca Fitness Systems has built this gym to give you a safe, effective and enjoyable workout. However, there is a risk assumed by individuals who use this type of equipment. It is very important that all warnings and instructions are read and followed before beginning any exercise program.

It is also very important to read and follow the preventative maintenance schedule described in this manual. If any of the warning labels or stickers are worn, faded, torn, scratched or missing they should be replaced immediately.

**WARNING: There is a risk assumed by individuals who use this type of equipment. To minimize risk always follow these rules.**

- 1) It is essential that you consult with your physician before beginning any exercise program.
- 2) Inspect equipment before each use for loose, worn, or frayed parts (including cables, nuts and bolts). Replace parts at first signs of wear (use only genuine BATCA replacement parts). Use of equipment that is damaged, worn, frayed or not completely assembled on a solid, level surface may result in injury.
- 3) Make sure all adjustment pins are fully engaged before using equipment.
- 4) Keep all parts of the body and clothing outside the path of any moving parts of the gym. Be alert to the possibility of injury. Do not be careless.
- 5) Minors and children should not be allowed to play on or around this gym.
- 6) If you have any questions on proper use or maintenance of this gym, do not hesitate to call your local BATCA FITNESS SYSTEMS distributor or BATCA FITNESS SYSTEMS at (919) 255-1233. [www.batcafitness.com](http://www.batcafitness.com)

# Table of Contents

	<u>Page</u>		<u>Page</u>
Instructions	2	Final Assembly and Troubleshooting	16
Parts Listing	3	Cable Tension and Adjustments	17
Hardware Comparison	4-7	Maintenance	18
Main Assembly	8-12	Warranty	19
Upholstery	13	Floor Plan Layout	20
Cable Routing	14-15		

## Frame Components

ITEM NO.	PART NUMBER	DESCRIPTION	QTY.
2	<b>BFM-10428</b>	Shoulder Arm	1
4	<b>BFM-10388</b>	Short Cage	1
5	<b>BFM-50527</b>	Guide Rod	2
7	<b>BFM-50615</b>	Guide Rod Plate	1
8	<b>BFM-10430</b>	Weight Plate	19
9	<b>BFM-10413</b>	3/4" 10lb Top Plate	1
10	<b>BFM-10387</b>	Base Connector	1
11	<b>BFM-10412</b>	Pulley Holder	1
12	<b>BFM-50531</b>	Shroud	1
13	<b>BFM-50638</b>	Counter Weight	2
14	<b>BFM-10385</b>	Shoulder Press Frame	1
15	<b>BFM-10386</b>	Elbow Support	1
16	<b>BFM-10153</b>	Chrome Pad Adjustment	1
22	<b>BFM-50345</b>	Pulley Cover	1
24	<b>BFM-50150</b>	Anti-Deflection Plate	1
25	<b>BFM-50126</b>	Anti-Deflection Plate	2
26	<b>BFM-50247</b>	5/8" Spacer	2
57	<b>BFM-50635</b>	Selector Shaft	1

## Cables

ITEM NO.	PART NUMBER	DESCRIPTION	QTY.
52	<b>CAB-12008</b>	Wt. Stack to Shoulder Press Cable	1

## Tools Required

- 9/16" Wrench
- 3/4" Wrench
- 9/16" Ratchet
- Allen Wrench Set
- Tape Measure

## Accessories

ITEM NO.	PART NUMBER	DESCRIPTION	QTY.
28	<b>BFC-50127</b>	Magnetic Weight Stack Pin	1

## Upholstery

ITEM NO.	PART NUMBER	DESCRIPTION	QTY.
17	<b>BFU-10118</b>	Bottom Pad	1
18	<b>BFU-10119</b>	Head Pad	1
19	<b>BFU-10120</b>	Back Pad With Lumbar	1

## Hardware

ITEM NO.	PART NUMBER	DESCRIPTION	QTY.
1	<b>BFH-50171</b>	Side Mounted Flange Bearing	2
3	<b>BFH-50253</b>	Beveled Leveler	1
6	<b>BFM-50529</b>	Rubber Donut	2
20	<b>BFH-50174</b>	4 1/2" Pulley	3
21	<b>BFH-50173</b>	3 1/2" Pulley	3
23	<b>BFH-50530</b>	5" Pulley	1
27	<b>BFH-50210</b>	Gas Spring	1
29	<b>BFH-50199</b>	Rubber Grommit	2
30	<b>BFH-50146</b>	3/8" Flat Washer (Black)	44
31	<b>BFH-50157</b>	3/8"-16 Nylock (Black)	22
32	<b>BFH-50201</b>	1/2" Pulley Spacer	6
33	<b>BFH-50147</b>	3/8" Lock Washer (Black)	10
34	<b>BFH-50267</b>	5/16"-18 Nylock (Black)	1
35	<b>BFH-50250</b>	1 1/4" Shoulder Bolt	1
36	<b>BFH-50126</b>	HCS 3/8"-16 X 3 1/4" P5	4
37	<b>BFH-50127</b>	HCS 3/8"-16 X 3 1/2" P5	2
38	<b>BFH-50128</b>	HCS 3/8"-16 X 3 3/4" P5	2
39	<b>BFH-50125</b>	HCS 3/8"-16 X 3" P5	2
40	<b>BFH-50130</b>	HCS 3/8"-16 X 4 1/4" P5	2
41	<b>BFH-50124</b>	HCS 3/8"-16 X 2 3/4" P5	4
42	<b>BFH-50122</b>	HCS 3/8"-16 X 2 1/4" P5	4
43	<b>BFH-50121</b>	HCS 3/8"-16 X 2" P5	2
44	<b>BFH-50129</b>	HCS 3/8"-16 X 4" P5	4
45	<b>BFH-50119</b>	HCS 3/8"-16 X 1 1/4" P5	2
46	<b>BFH-50254</b>	HCS 3/8"-16 X 3/4" P5	4
47	<b>BFH-50149</b>	3/8"-16 Jam Nut (Zinc)	1
48	<b>BFH-50255</b>	Rubber Foot	5
53	<b>BFH-50118</b>	HCS 3/8"-16 X 1" P5	4
54	<b>BFH-50227</b>	Cable Strap	1

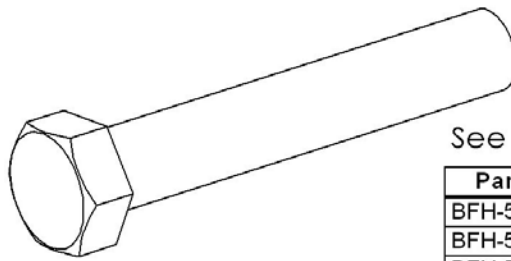
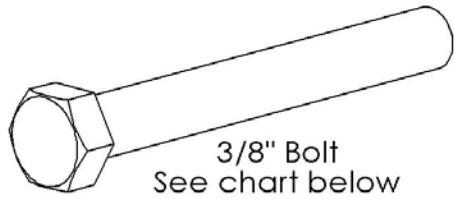

Part #	Size
BFH-50254	3/8" x 3/4"
BFH-50118	3/8" x 1"
BFH-50119	3/8" x 1 1/4"
BFH-50120	3/8" x 1 1/2"
BFH-50285	3/8" x 1 3/4"
BFH-50121	3/8" x 2"
BFH-50122	3/8" x 2 1/4"
BFH-50123	3/8" x 2 1/2"
BFH-50124	3/8" x 2 3/4"
BFH-50125	3/8" x 3"
BFH-50126	3/8" x 3 1/4"
BFH-50127	3/8" x 3 1/2"
BFH-50128	3/8" x 3 3/4"
BFH-50129	3/8" x 4"
BFH-50130	3/8" x 4 1/4"
BFH-50131	3/8" x 4 1/2"
BFH-50274	3/8" x 4 3/4"
BFH-50279	3/8" x 5"
BFH-50270	3/8" x 5 1/4"
BFH-50132	3/8" x 5 1/2"
BFH-50133	3/8" x 6 1/2"
BFH-50298	3/8" x 8 3/4"
BFH-50134	3/8" x 9"

Part #	Size
BFH-50135	1/2" x 2 3/4"
BFH-50136	1/2" x 3"
BFH-50137	1/2" x 3 1/4"
BFH-50138	1/2" x 3 1/2"
BFH-50139	1/2" x 4 1/4"
BFH-50140	1/2" x 4 1/2"
BFH-50141	1/2" x 5 1/2"

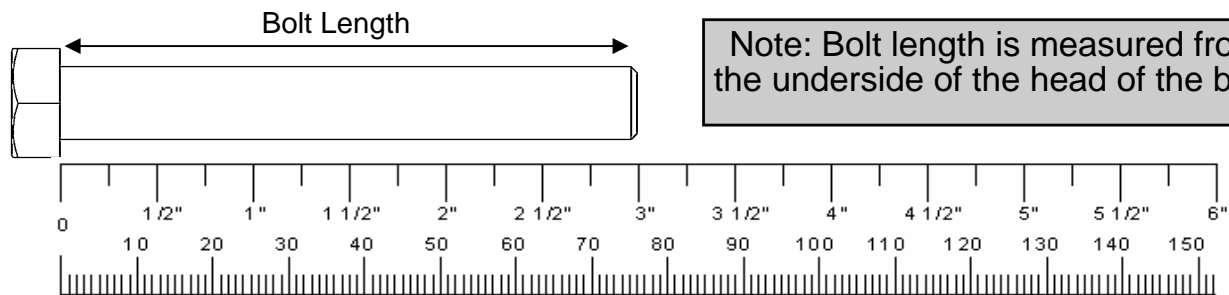
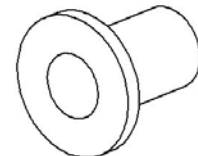
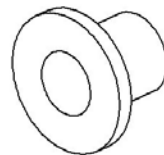
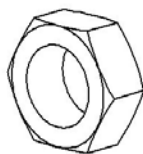
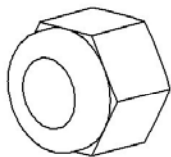
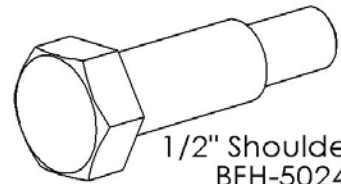
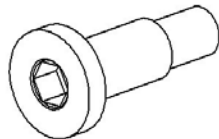
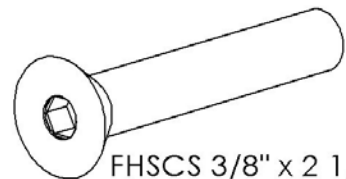
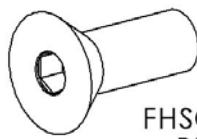

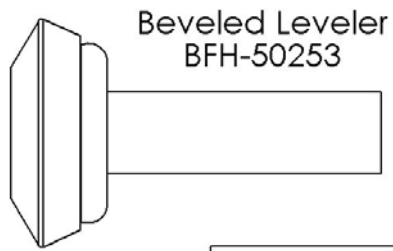

Beveled Leveler  
BFH-50253

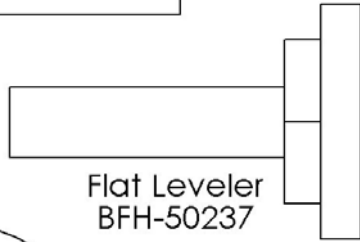

Flat Leveler  
BFH-50237

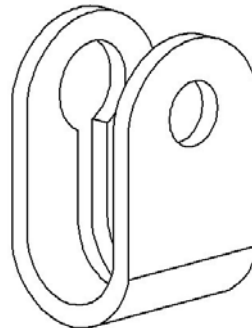

Cable Strap  
BFH-50227

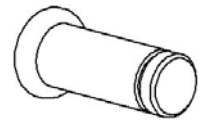

Pin  
BFH-50238



Snap Ring  
BFH-50239

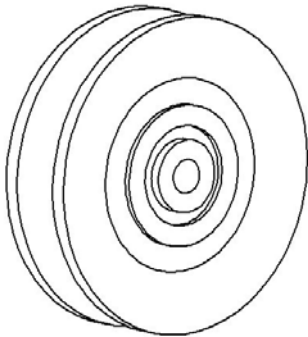

3 1/2" Pulley  
BFH-50173

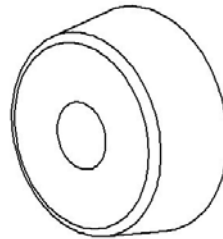

Rubber Donut  
BFH-50190

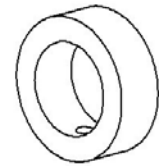

Threaded Collar  
BFH-50220

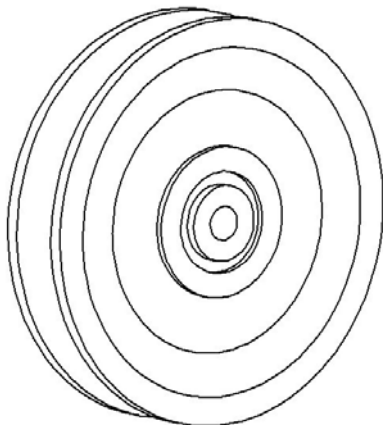

4 1/2" Pulley  
BFH-50174

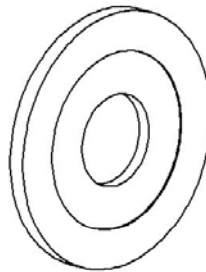

3" Plastic Washer  
BFH-50221

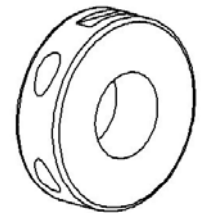

Plastic Collar  
BFH-252

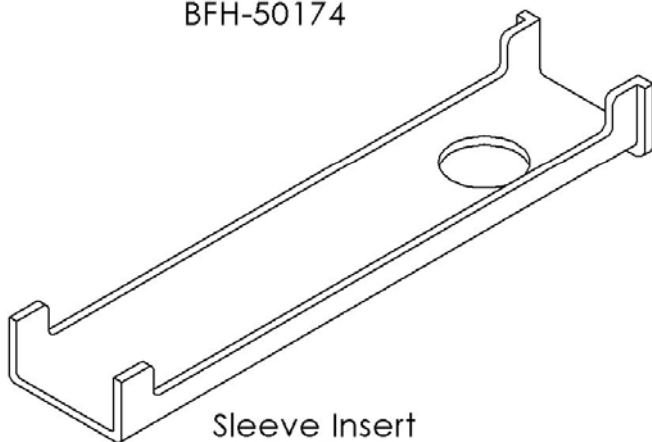

Sleeve Insert  
BFH-50175

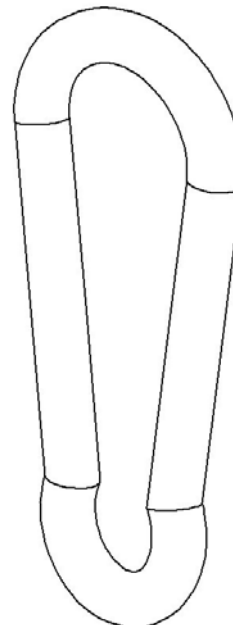

Snap Hook  
BFH-50188

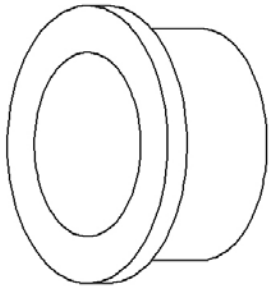

1" Bronze Bushing  
BFH-50101

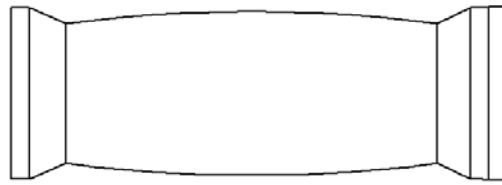

Molded Grip - BFH-50110

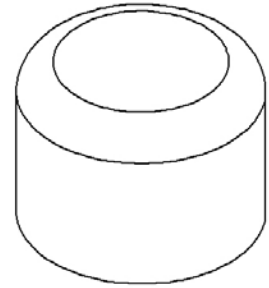

1" Outer Plastic Cap  
BFH-50111

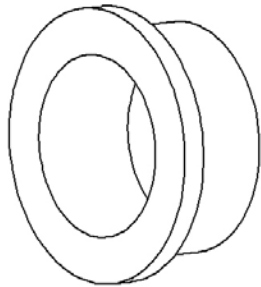

1" Bronze Bushing x 1/2 L  
BFH-50297

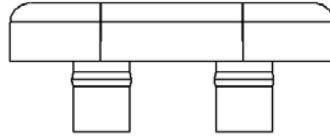

BFH-50222

Rubber Bumpers

BFH-50200

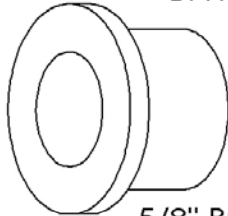
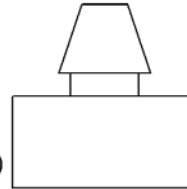

5/8" Bronze Bushing  
BFH-50102

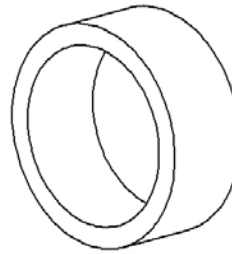

5/8" Spacer  
BFM-50247

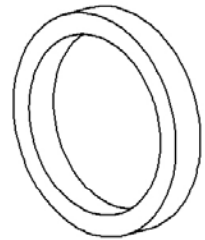

3/16" Spacer  
BFM-50246

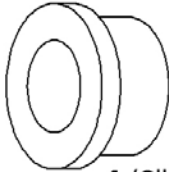

1/2" Bronze Bushing  
BFH-50103

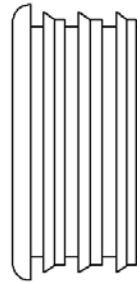

1 1/2" Inner Plastic Cap  
BFH-50114



Cable Pivot Bushing  
BFH-50248

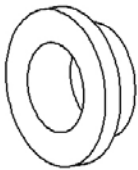

Short 1/2" Bushing  
BFH-50244

1" Inner Plastic Cap  
BFH-50280

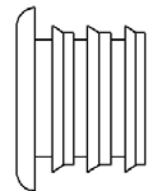

1/2" Snap Ring  
BFH-50166

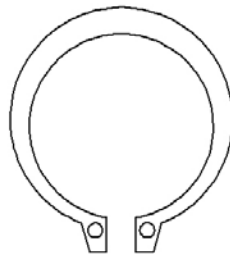

1" Snap Ring  
BFH-50165

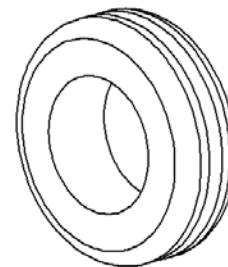

Rubber Grommet  
BFH-50199

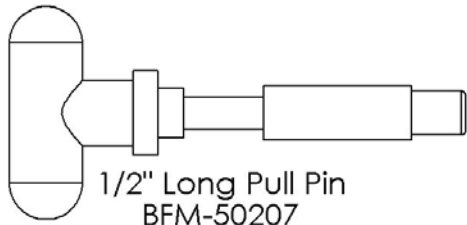

1/2" Long Pull Pin  
BFM-50207

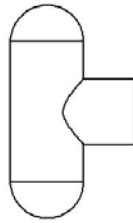

Pull Pin T-Handle  
BFM-50263

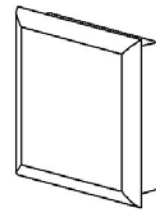

Plastic Cap

Part #	Size
BFH-50211	2" x 2"
BFH-50212	2" x 3"
BFH-50213	1 1/2" x 2"
BFH-50214	1 3/4" x 1 3/4"
BFH-50215	1 1/2" x 1 1/2"

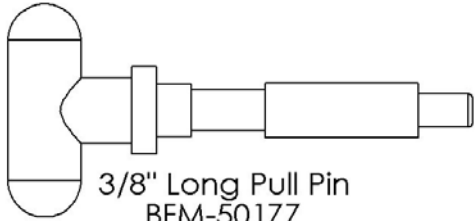

3/8" Long Pull Pin  
BFM-50177

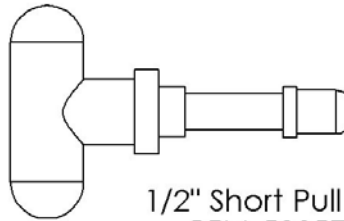

1/2" Short Pull Pin  
BFM-50157

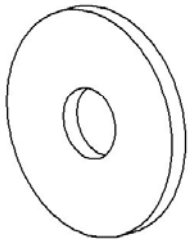

3/8" Fender Washer  
BFH-50242

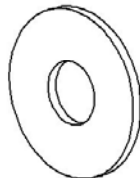

3/8" Flat Washer  
BFH-50146

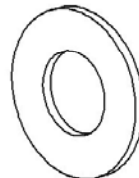

1/2" Flat Washer  
BFH-50251

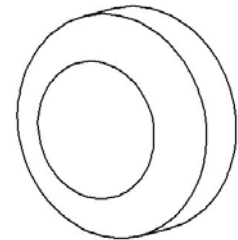

Screw Cap Cover  
BFH-50112

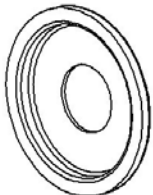

Screw Cap Washer  
BFH-50113



3/8" Lock Washer  
BFH-50147

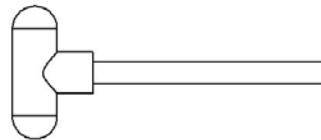

Weight Stack Pin  
BFC-50127

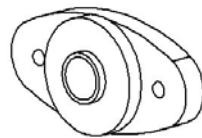

Side Mounted  
Flange Bearing  
BFH-50171

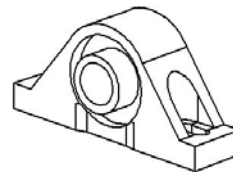

Pillow Block Bearing  
BFH-50172

Items not shown.

Part #	Description
BFH-50259	Midnight Black Paint
BFH-50278	Silver Metallic Paint
BFH-50198	Large Logo
BFH-50197	Small Logo
BFH-50236	Foam Grip
BFH-50246	Anti Skid
BFH-50262	Silicon Gel Pack
BFC-10101	1 inch chain
BFC-10102	12 inch chain

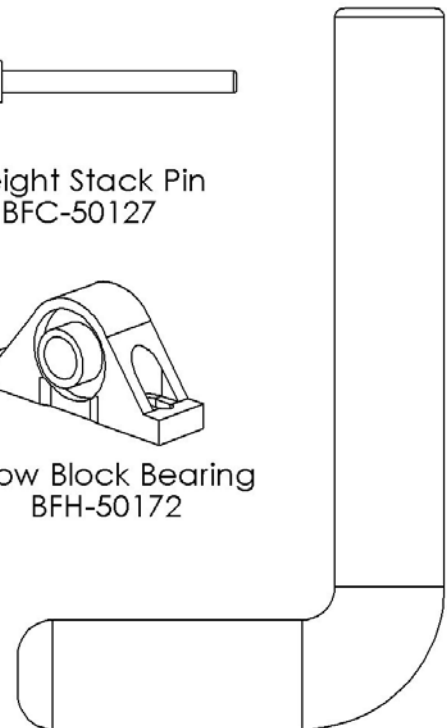

Bar Catch Rubber Sleeve  
BFH-50240



**PLEASE FOLLOW ALL DIRECTIONS VERY CAREFULLY FOR PROPER INSTALLATION.**

**Step 1:**



**Note:** For a more consistent appearance, position all bolts in the direction shown in each figure.

- All Flat Washers and Nylocks are 3/8" unless otherwise noted.

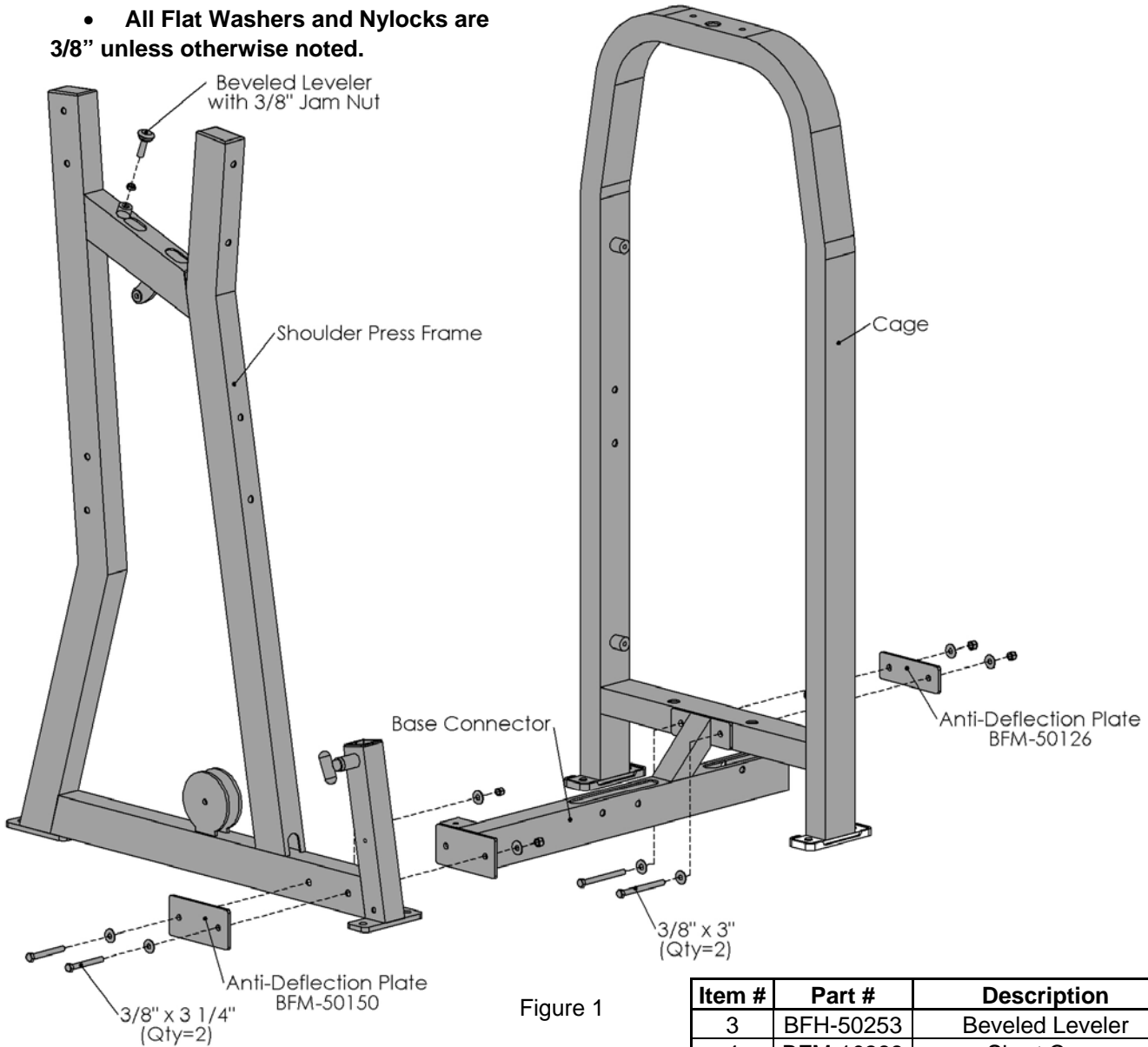

Figure 1

Item #	Part #	Description	Qty
3	BFH-50253	Beveled Leveler	1
4	BFM-10388	Short Cage	1
10	BFM-10387	Base Connector	1
14	BFM-10385	Shoulder Press Frame	1
24	BFM-50150	Anti-Deflection Plate	1
25	BFM-50126	Anti-Deflection Plate	1
30	BFH-50146	3/8" Flat Washer (Black)	8
31	BFH-50157	3/8"-16 Nylock (Black)	4
36	BFH-50126	HCS 3/8"-16 x 3 1/4" P5	2
39	BFH-50125	HCS 3/8"-16 x 3" P5	2
47	BFH-50149	3/8"-16 Jam Nut (Zinc)	1
48	BFH-50255	Rubber Foot	5



**Step 2:**

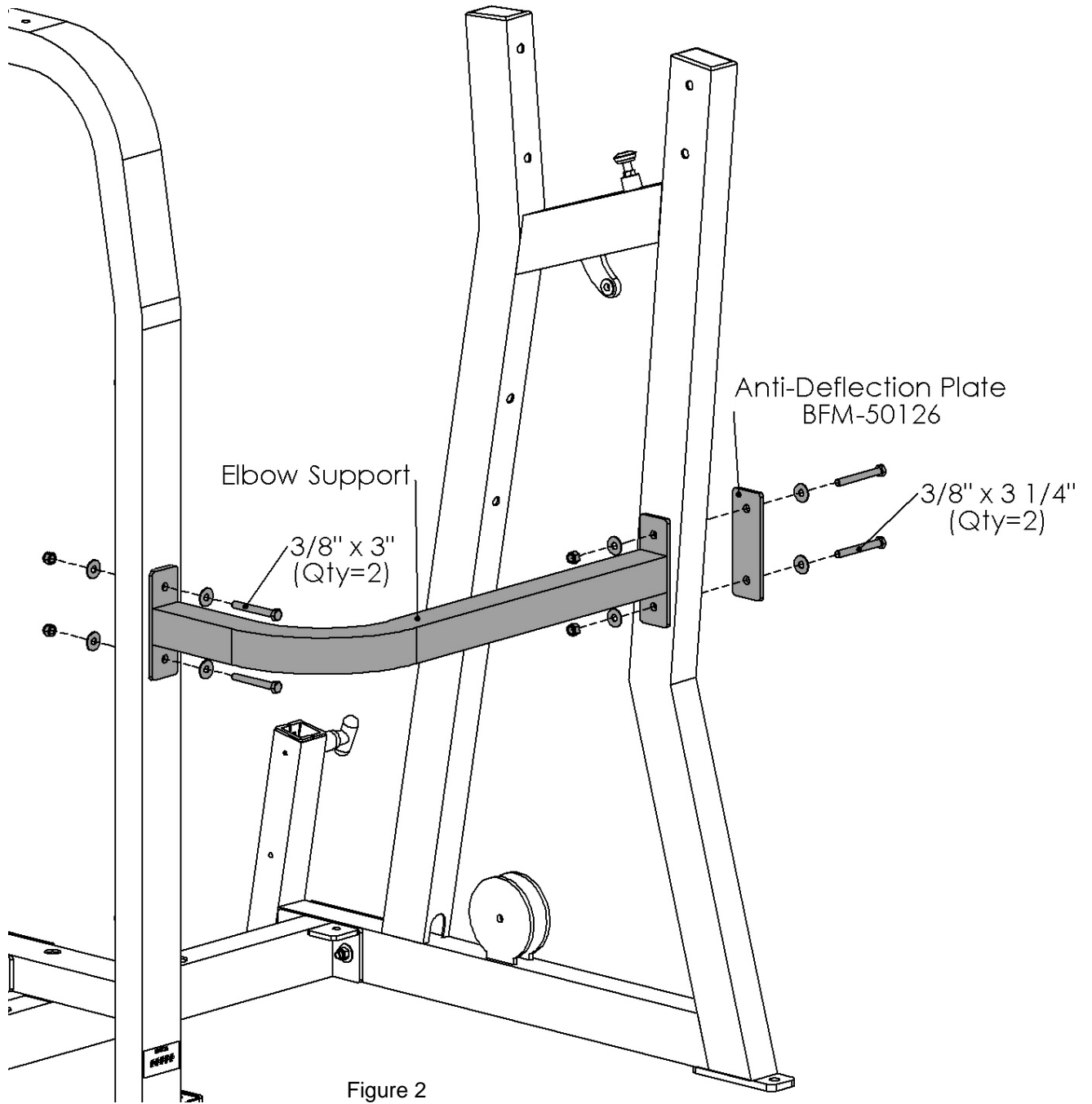

Figure 2

Item #	Part #	Description	Qty
15	BFM-10386	Elbow Support	1
25	BFM-50126	Anti-Deflection Plate	1
30	BFH-50146	3/8" Flat Washer (Black)	8
31	BFH-50157	3/8"-16 Nylock (Black)	4
36	BFH-50126	HCS 3/8"-16 x 3 1/4" P5	2
39	BFH-50125	HCS 3/8"-16 x 3" P5	2

All Flat Washers and Nylocks are 3/8" unless otherwise noted.

### Step 3:

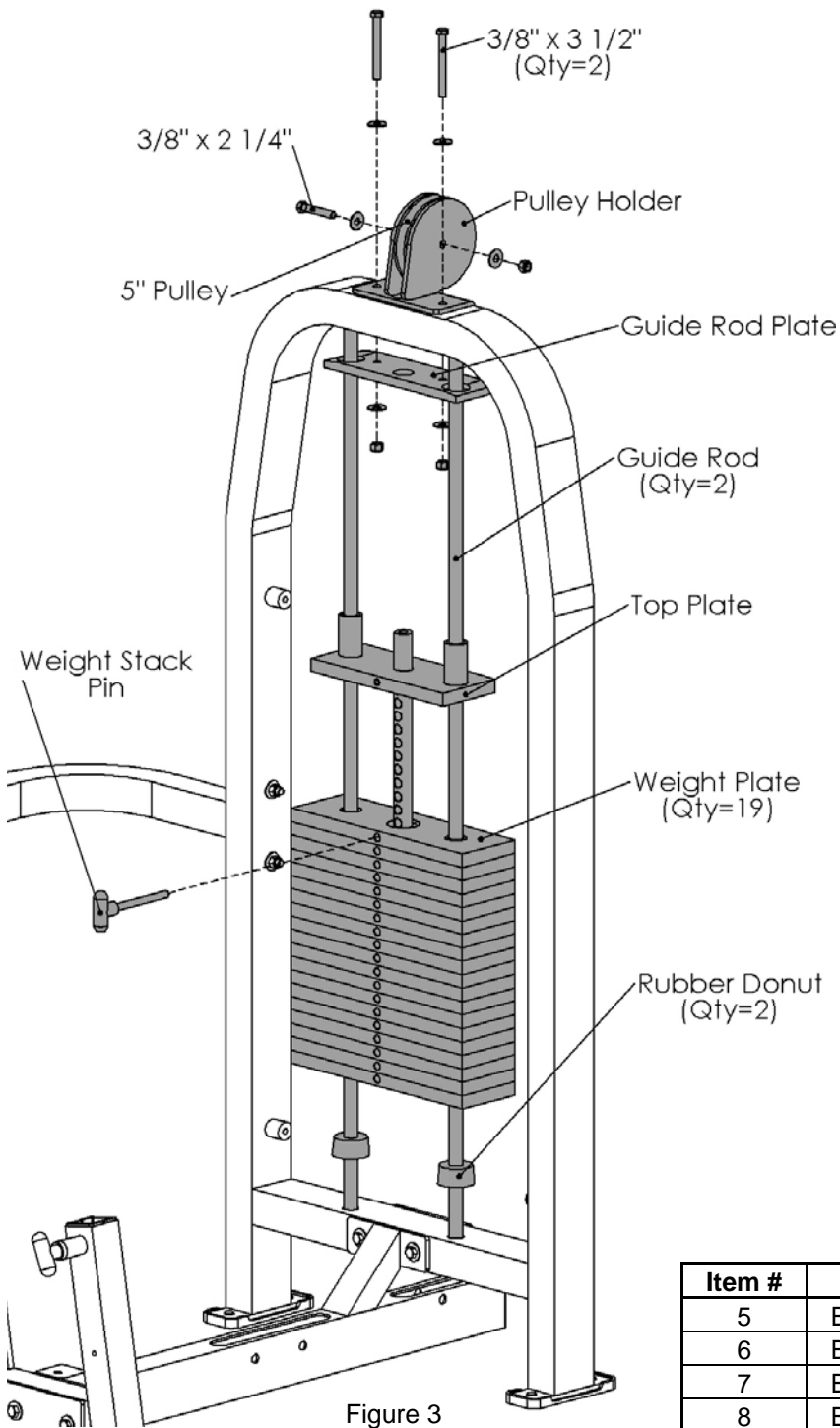

Figure 3

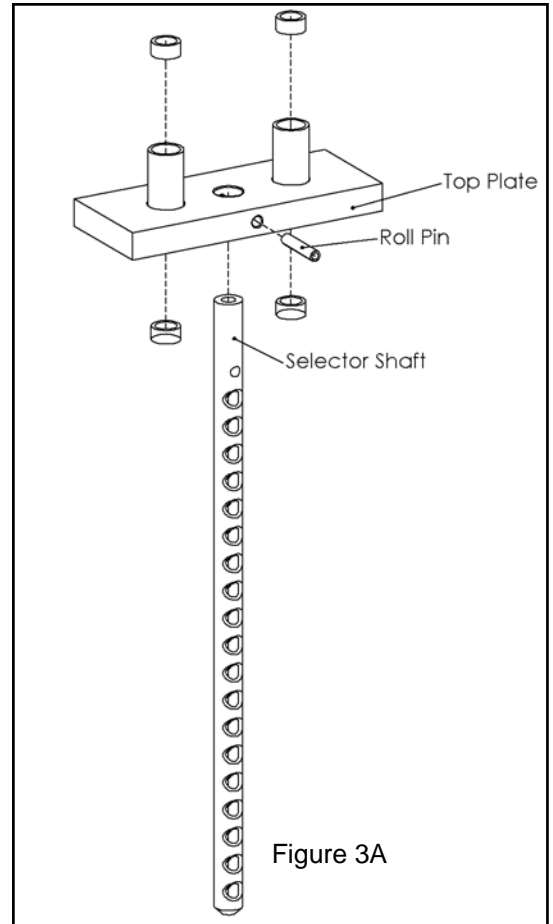

Figure 3A

Item #	Part #	Description	Qty
5	BFM-50527	Guide Rod	2
6	BFM-50529	Rubber Donut	2
7	BFM-50615	Guide Rod Plate	1
8	BFM-10430	Weight Plate	19
9	BFM-10413	3/4" 10lb Top Plate	1
11	BFM-10412	Pulley Holder	1
23	BFH-50530	5" Pulley	1
28	BFC-50127	Magnetic Weight Stack Pin	1
30	BFH-50146	3/8" Flat Washer (Black)	6
31	BFH-50157	3/8"-16 Nylock (Black)	3
37	BFH-50127	HCS 3/8"-16 x 3 1/2" P5	2
42	BFH-50122	HCS 3/8"-16 x 2 1/4" P5	1
57	BFM-50635	Selector Shaft	1

All Flat Washers and Nylocks are 3/8" unless otherwise

**Step 4:**

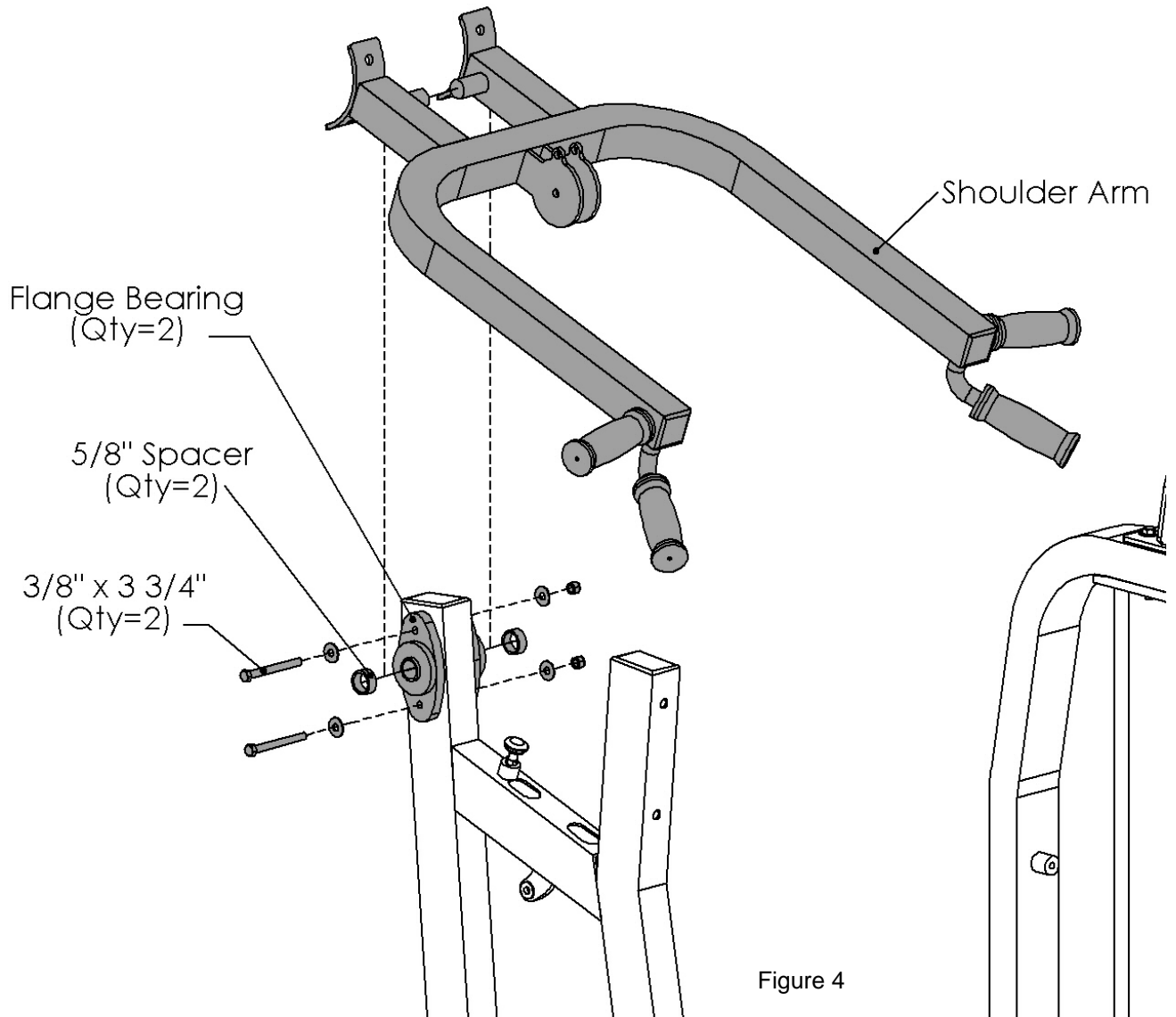
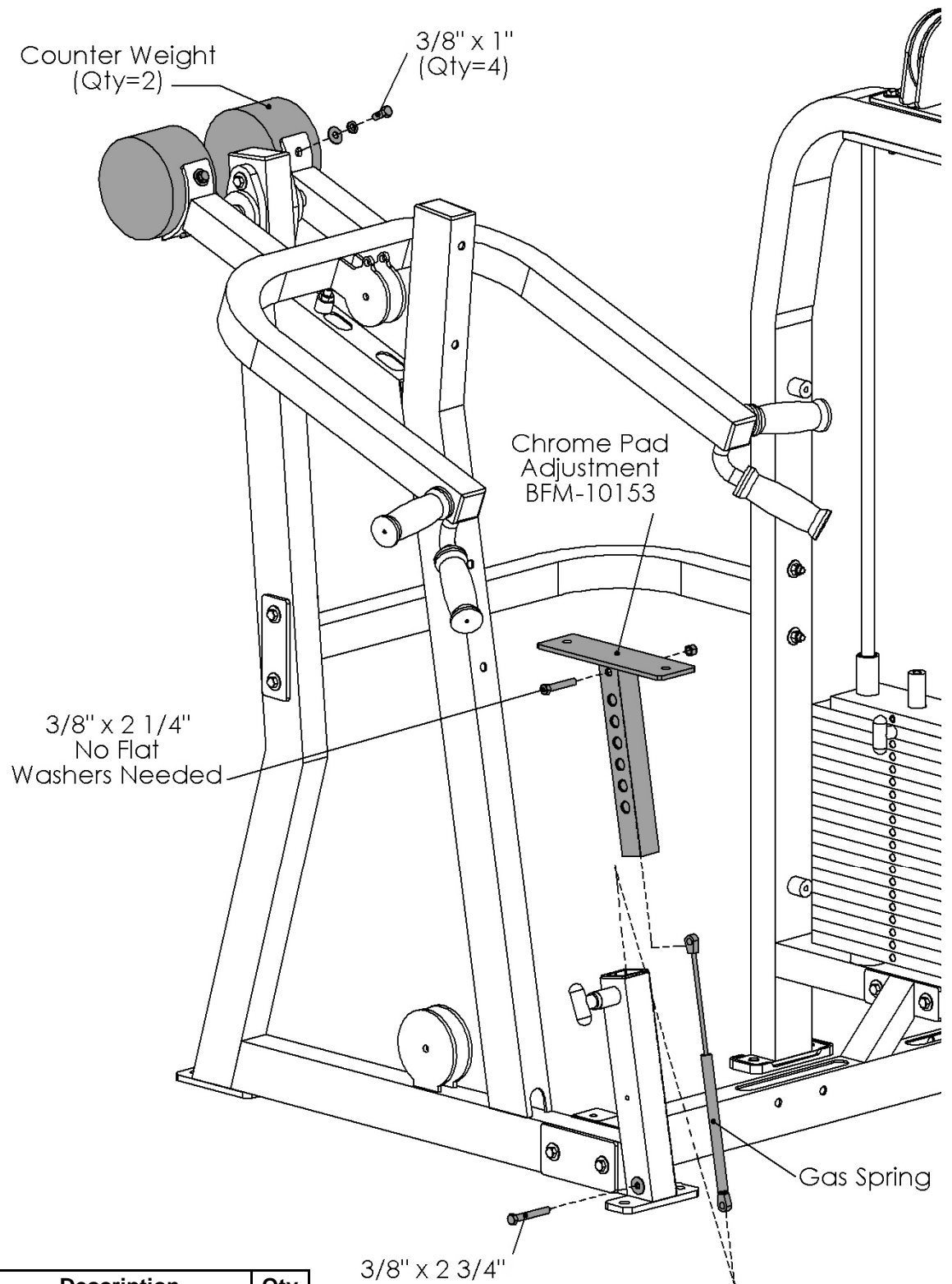

Figure 4

Item #	Part #	Description	Qty
1	BFH-50171	Side Mounted Flange Bearing	2
2	BFM-10428	Shoulder Arm	1
26	BFM-50247	5/8" Spacer	2
30	BFH-50146	3/8" Flat Washer (Black)	4
31	BFH-50157	3/8"-16 Nylock (Black)	2
38	BFH-50128	HCS 3/8"-16 x 3 3/4" P5	2

All Flat Washers and Nylocks are 3/8" unless otherwise noted.

**Step 5:**



3/8" x 2 3/4"

Figure 5

Item #	Part #	Description	Qty
13	BFM-50638	Counter Weight	2
16	BFM-10153	Chrome Pad Adjustment	1
27	BFH-50210	Gas Spring	1
30	BFH-50146	3/8" Flat Washer (Black)	6
31	BFH-50157	3/8"-16 Nylock (Black)	2
33	BFH-50147	3/8" Lock Washer (Black)	4
41	BFH-50124	HCS 3/8"-16 x 2 3/4" P5	1
42	BFH-50122	HCS 3/8"-16 x 2 1/4" P5	1
53	BFH-50118	HCS 3/8"-16 x 1" P5	4

All Flat Washers and Nylocks are 3/8" unless otherwise noted.

## Step 6:

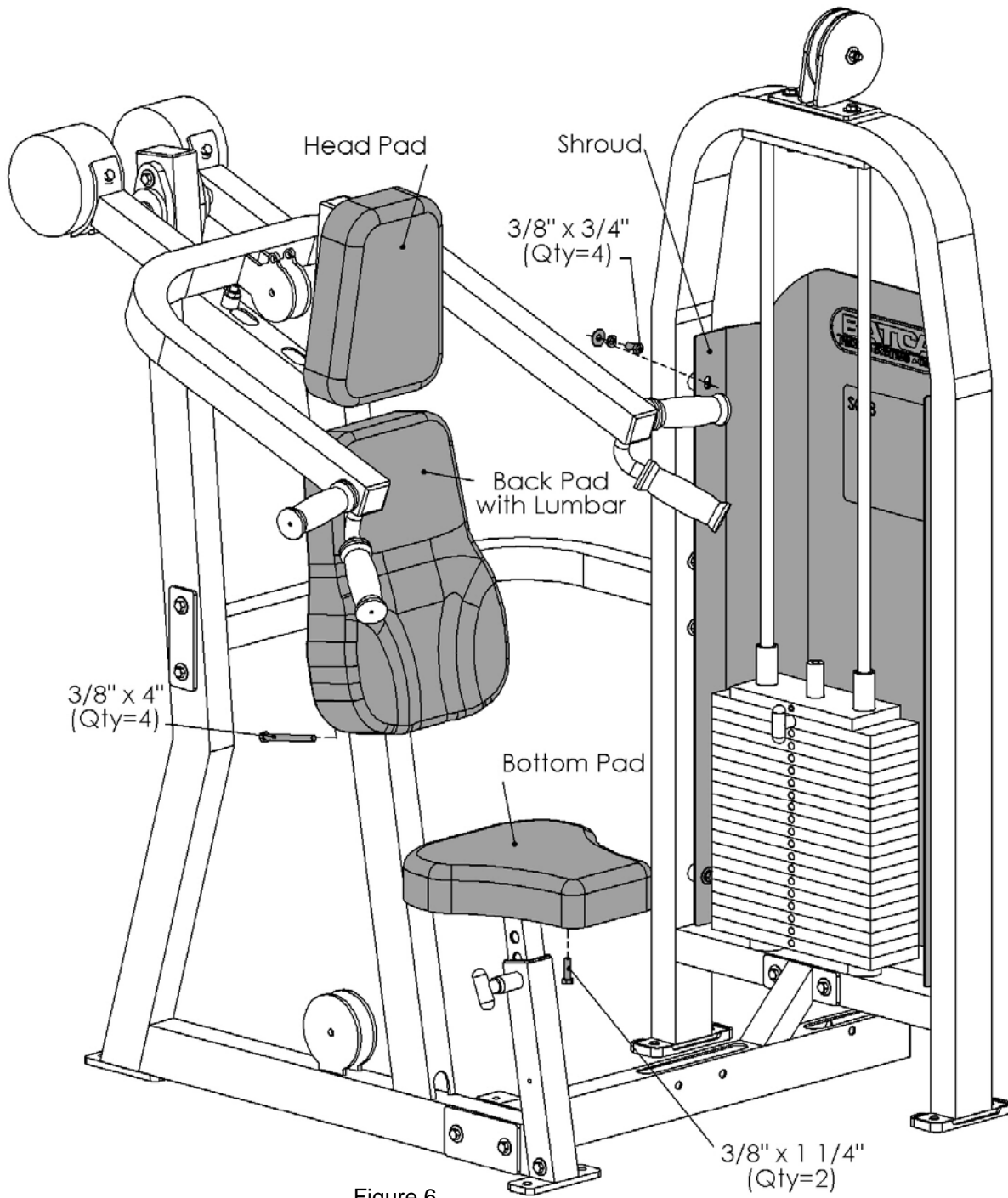

Figure 6

- Note: All bolts in this step receive one 3/8" Flat washer and one 3/8" Lock Washer instead of one 3/8" Nylock.

Item #	Part #	Description	Qty
12	BFM-50531	Shroud	1
17	BFU-10118	Bottom Pad	1
18	BFU-10119	Head Pad	1
19	BFU-10120	Back Pad with Lumbar	1
30	BFH-50146	3/8" Flat Washer (Black)	10
33	BFH-		

All Flat Washers and Nylocks are 3/8" unless otherwise noted.